



PARTS CATALOGUE



Engine Model	Applied Vehicle Model
CF188-A	CF500-3 (RANCHER)

Issued by CFMOTO
on Nov. 15th, 2009

DRAWING INDEX

E01 CRANKCASE ASSY

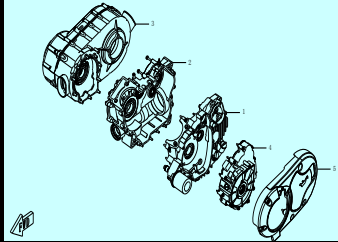

E02 LEFT CRANKCASE

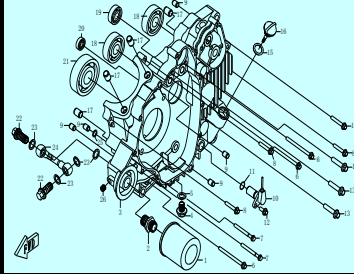

E03 RIGHT CRANKCASE

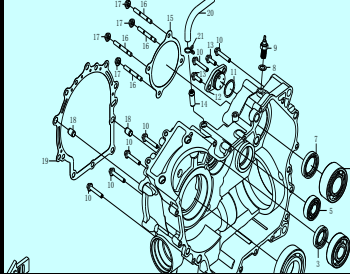

E04 CVT HOUSING

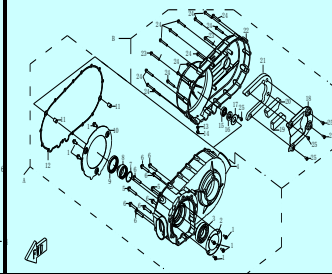

E05 CRANKCASE COVER (LEFT)

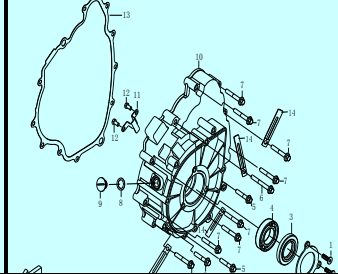

E06 CYLINDER, CYLINDER ASSEY.

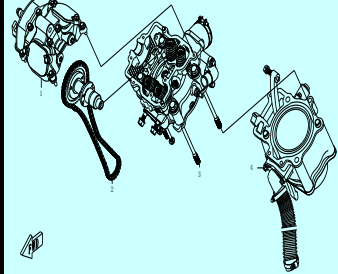

E07 CYLINDER HEAD COVER

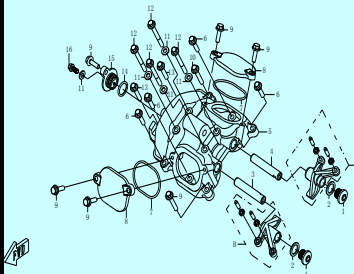

E08 CYLINDER HEAD

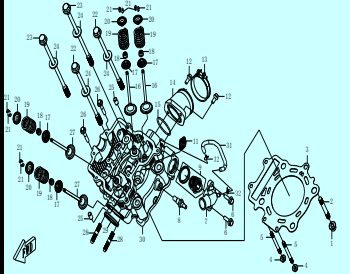

E09 CYLINDER BODY

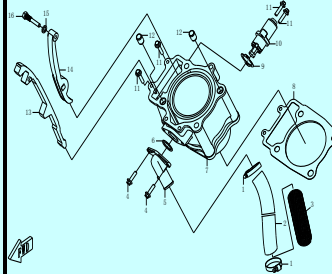

E10 CAMSHAFT ASSY.

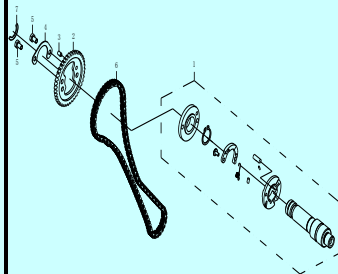

E11 MAGNETO STATOR ASSY.

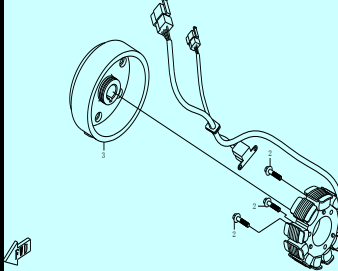

E12 CRANKSHAFT, PISTON, BALANCER

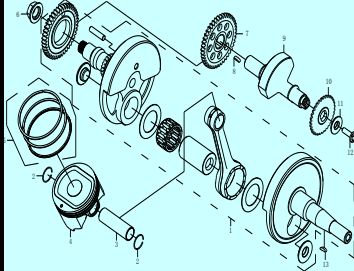

E13 CLUTCH, CVT

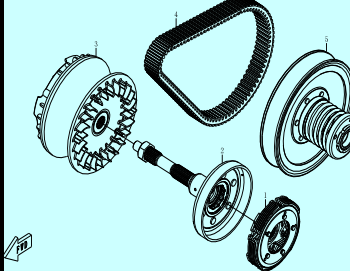

E14 PRIMARY SHEAVE

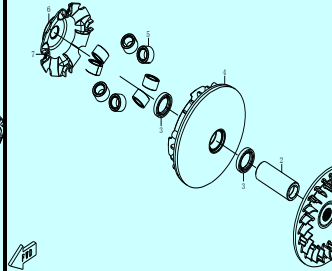

E15 SECONDARY SHEAVE

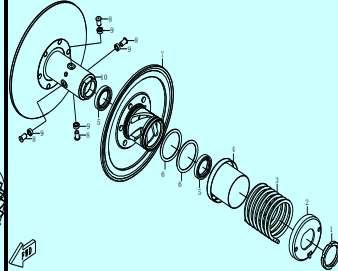

E16 CLUTCH HOUSING

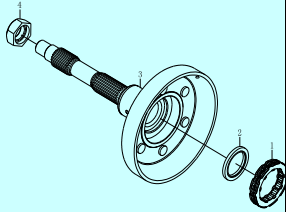

E17 CLUTCH ASSY.

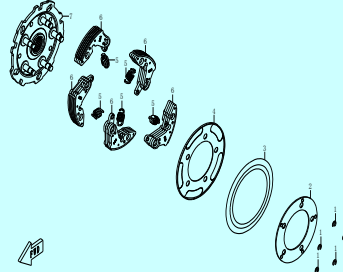

E18 TRANSMISSION I

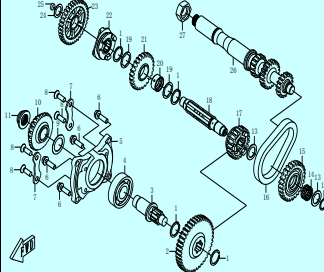

E19 TRANSMISSION II

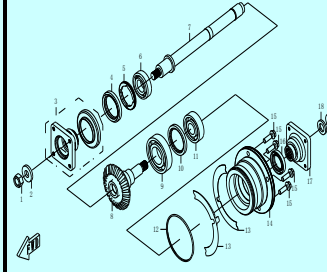

E20 TRANSMISSION III

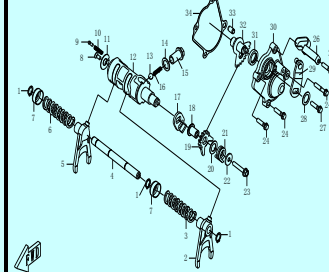

E21 OIL PUMP

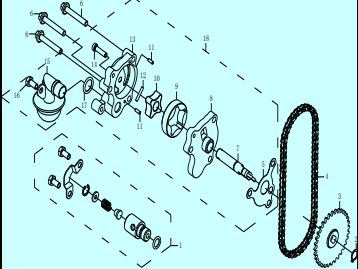

E22 WATER PUMP ASSY.

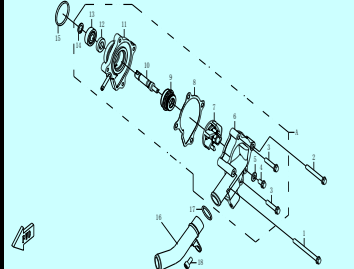

E23 ELECTRIC STARTING

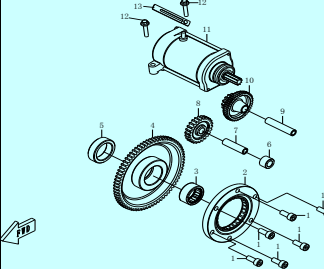

E24 CARBURETOR

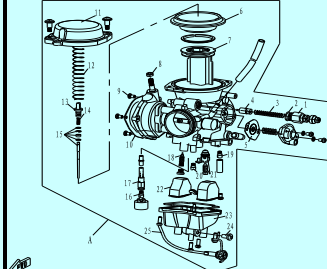

E25 COOLING FAN ASSY.

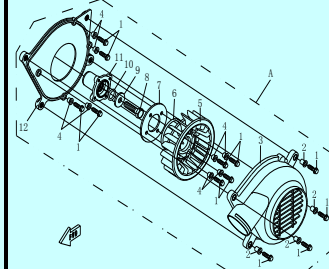

PART INDEX

Item No.	Old Part No.	New Part No.	Part Name (EN)	QTY	REF. No.
1	CF188-011000	0180-011000	LEFT CRANKCASE	1	E01
2	CF188-012000	0180-012000	RIGHT CRANKCASE	1	E01
3	CF188-013000	0180-013000	CVT HOUSING	1	E01
4	CF188-014000	0180-014000	CRANKCASE COVER (LEFT)	1	E01
5	CF188-015000	0180-015000	LEFT SIDE COVER ASSY	1	E01
1	CF188-011300	0180-011300-0B00	OIL FILTER	1	E02
2	CF188-011004	0180-011004-0010	BOLT, OIL FILTER	1	E02
3	CF188-011100	0180-011100-0080	LEFT CRANKCASE	1	E02
4	172MM-013005	0110-013005-0030	DRAIN BOLT M12×1.25	1	E02
5	152MI-021014	0010-021014	WASHER 12	1	E02
6	172MM-013031	0110-013031-0030	BOLT M6×80	3	E02
7	152MI-011017	0010-011017-0030	BOLT M6×60	2	E02
8	152MI-013008	0010-013008-0030	BOLT M6×35	3	E02
9	152MI-021005	0010-021005	DOWEL PIN, φ10×14	5	E02
10	172MM-B-011300	0130-011300	SPEED SENSOR	1	E02
11	172MM-B-011303	0130-011303	O-RING 14×1.44	1	E02
12	152MI-090005	0010-090005-0030	BOLT M6×16	1	E02
13	172MM-060010	0110-060010-0030	BOLT M8×38	3	E02
14	152MI-013009	0010-013009-0030	BOLT M6×40	1	E02
15	172MM-013030	0110-013030	O-RING 18×3.55	1	E02
16	172MM-013001	0110-013001	OIL DIP ROD	1	E02
17	CF188-011005	0180-011005	DOWEL PIN, φ13×18	4	E02
18	GB/T276/6303	30400-01701	BEARING 6303(17×47×14)	2	E02
19	GB/T276/6202	30499-01500	BEARING 6202	1	E02
20	GB/T276/63/22	30400-02200	BEARING 63/22	1	E02
21	GB/T276/6307	30499-03500	BEARING 6307	1	E02
22	CF188-011007	0180-011007-0030	HINGE BOLT M14×1.5	2	E02
23	CF188-011006	0180-011006	GASKET 14	4	E02
24	CF188-011400	0180-011400-0030	EXTERNAL OIL PIPE SET	1	E02
25	GB3452.1/10x1.8	30502-010000N	O-RING	1	E02
26	GB/T77/M10×10	30131-100010810	SCREW	1	E02
1	CF188-012100	0180-012100-0080	RIGHT CRANKCASE	1	E03
2	GB/T276/6208	30499-04000	BEARING 6208	1	E03
3	CF188-012004	0180-012004	OIL SEAL 22×38×7	1	E03

4	GB/T276/63/22	30400-02200	BEARING 63/22	1	E03
5	GB/T276/6203-RZ	30400-01703	BEARING 6203-RZ	1	E03
6	GB/T296/3206A	30499-03000	BEARING 3206A	1	E03
7	CF188-012006	0180-012006	OIL SEAL 30×45×7	1	E03
8	152MI-060010	0010-060010	WASHER 10	1	E03
9	CF188-012300	0180-012310-0010	REVERSE GEAR SENSOR	1	E03
10	152MI-013008	0010-013008-0030	BOLT M6×35	6	E03
11	CF188-023002	0180-023002	O-RING 24×2.5	1	E03
12	CF188-012200	0180-012200	GEAR POSITION SENSOR	1	E03
13	152MI-023008	0010-023008-0030	BOLT M6×18	2	E03
14	152MI-013006	0010-013006-0010	JOINT, BREATHER HOSE	1	E03
15	CF188-012002	0180-012002	GASKET 2, CVT HOUSING	1	E03
16	GB/T900/AM6×40-8.8	30011-060040820	BOLT	4	E03
17	GB/T6187.1/M6	30204-060810	NUT	4	E03
18	152MI-021005	0010-021005	DOWEL PINφ10×14	2	E03
19	CF188-012001	0180-012001	GASKET 1, CVT HOUSING	1	E03
20	CF188-012008	0180-012008	BREATHER HOSE	1	E03
21	QC/T621/A12	30601-112050	CLAMP A12	1	E03
A	CF188-013100	0180-013100	CVT HOUSING COMP.	1	E04
1	152MI-021019	0010-021019-0030	BOLT M6×12	7	E04
2	CF188-013108	0180-013108-0010	BEARING RETAINER, CVT	1	E04
3	GB/T276/6208-RS	30499-04001	BEARING 6208	1	E04
4	CF188-013101	0180-013101-0080	CVT CASE	1	E04
5	1P39MB-012006	0040-012006-0030	BOLT M8×50	2	E04
6	1P39MB-012005	0040-012005-0030	BOLT M8×45	8	E04
7	CF188-022011	0180-022011	O-RING 40×2.4	1	E04
8	CF188-013106	0180-013106-0050	SPACER, DRIVE SHAFT	1	E04
9	CF188-013105	0180-013105	OIL SEAL 54×70×8	1	E04
10	CF188-013102	0180-013102-0010	PLATE, AIR INTAKE	1	E04
11	CF188-011005	0180-011005	DOWEL PINφ13×18	2	E04
12	CF188-013103	0180-013103	RUBBER GASKET, CVT CASE	1	E04
B	CF188-013200	0180-013200	CVT COVER COMP.	1	E04
13	152MI-060009	0010-060009	WASHER 6	1	E04
14	152MI-080010	0010-080010-0030	BOLT M6×10	1	E04
15	GB/T276/6003	30400-01702	BEARING 6003	1	E04
16	CF188-013207	0180-013207	OIL SEAL 17×35×5	1	E04
17	CF188-013206	0180-013206-0010	LIMITATOR, OIL SEAL	1	E04

18	CF188-013205	0180-013205-0010	DAMPER PLATE	1	E04
19	CF188-013204	0180-013204	RUBBER DAMPER(2)	1	E04
20	CF188-013203	0180-013203	RUBBER DAMPER(1)	1	E04
21	CF188-013202	0180-013202	RUBBER DAMPER(3)	1	E04
22	CF188-013201	0180-013201-0B00	CVT COVER	1	E04
23	152MI-021018	0010-021018-0030	BOLT M6×55	2	E04
24	CF188-013208	0180-013208-0030	BOLT M6×45	14	E04
25	GB/T818/M6×12	30105-060012420	SCREW M6×12	5	E04
1	CF188-014009	0180-014009-0010	HOLDER SCREW, OIL SEAL	3	E05
2	CF188-014007	0180-014007-0010	HOLDER,OIL SEAL	1	E05
3	CF188-014008	0180-014008	OIL SEAL 28×52×7	1	E05
4	GB/T276/60/28	30400-02800	BEARING60/28	1	E05
5	152MI-080012	0010-080012-0030	BOLT M6×32	3	E05
6	152MI-013010	0010-013010-0030	BOLT M6×50	1	E05
7	152MI-013009	0010-013009-0030	BOLT M6×40	8	E05
8	152MI-021009	0010-021009	SEAL RING, PLUG	1	E05
9	152MI-021008	0010-021008-0030	PLUG, INSPECTION	1	E05
10	CF188-014001	0180-014001-0080	COVER, LEFT CRANKCASE	1	E05
11	CF188-014003	0180-014003-0010	LEAD HOLDER	1	E05
12	CF188-014004	0180-014004-0020	BOLT, LEAD HOLDER	2	E05
13	CF188-014002	0180-014002	GASKET, LEFT CRANKCASE COVER	1	E05
14	CF188-014010	0180-014010	CLAMP	4	E05
2	CF188-024000	0180-024000	CAMSHAFT ASSY.	1	E06
4	CF188-023000	0180-023000	CYLINDER BODY	1	E06
5	CF188-020001	0180-020001	CYLINDER HEAD & HEAD COVER	1	E06
1	CF188-021008	0180-021008-0030	BOLT M14×1.25×12	2	E07
2	CF188-011006	0180-011006	WASHER 14	2	E07
A	CF188-021100	0180-021100	ROCKER ARM COMP, INTAKE	1	E07
B	CF188-021200	0180-021200	ROCKER ARM COMP. EXHAUST	1	E07
3	CF188-021005	0180-021005	ROCKER ARM SHAFT, EXHAUST	1	E07
4	CF188-021004	0180-021004	ROCKER ARM SHAFT, INTAKE	1	E07
6	152MI-021017	0010-021017-0030	BOLT M6×25	4	E07
7	CF188-021003	0180-021003	GASKET	2	E07
8	CF188-021002	0180-021002-0080	COVER, VALVE ADJUST	2	E07
9	152MI-023010	0010-023010-0030	BOLT M6×20	5	E07
10	152MI-013008	0010-013008-0030	BOLT M6×35	2	E07

11	152MI-060009	0010-060009	WASHER 6	5	E07
12	152MI-021018	0010-021018-0030	BOLT M6×55	4	E07
13	152MI-060012	0010-060012-0030	BOLT M6×30	2	E07
14	CF188-021010	0180-021010	O-RING 18×2.4	1	E07
15	CF188-021009	0180-021009-0080	SEAL COVER	1	E07
16	152MI-021019	0010-021019-0030	BOLT M6×12	1	E07
1	152MI-011700	0010-011700-0010	THRUST NUT M8	1	E08
2	CF188-022009	0180-022009-0010	STUD M8×68	1	E08
3	CF188-022200	0180-022200	GASKET,CYLINDER HEAD	1	E08
4	GB/T6187.1/M6	30204-060810	NUT	2	E08
5	CF188-022001	0180-022001-0020	STUD M6×70	2	E08
6	152MI-080013	0010-080013-0030	BOLT M6×22	2	E08
7	1P72MM-022200	01A0-022200	WATER OUTLET JOINT, CYLINDER HEAD	1	E08
8	152MI-022600	0010-022600	WATER TEMPERATURE SENSOR	1	E08
9	CF188-022810	0180-022810	THERMOSTAT	1	E08
10	1P72MM-022102	01A0-022102	PIPE JOINT	1	E08
11	172MM-022400	0110-022400	SPARK PLUG	1	E08
12	CF188-022010	0180-022010-0010	SCREW M6	2	E08
13	CF188-022400	0180-022400-0050	AIR INLET PIPE CLAMP	1	E08
14	CF188-022900	0180-022900	JOINT, CARBURETOR	1	E08
15	CF188-022011	0180-022011	O-RING 40×2.4	1	E08
16	CF188-022004	0180-022004	VALVE, INTAKE	2	E08
17	CF188-022008	0180-022008-0050	LOWER SEAT, VALVE SPRING	4	E08
18	152MI-022500	0010-022500	SEAL RING SET, VALVE STEM	4	E08
19	CF188-022006	0180-022006-0050	VALVE SPRING	4	E08
20	CF188-022007	0180-022007-0050	UPPER SEAT, VALVE SPRING	4	E08
21	152MI-022006	0010-022006-0030	LOCK CLIP, VALVE	8	E08
22	CF188-022012	0180-022012-0010	CYLINDER BOLT(L)	2	E08
23	CF188-022013	0180-022013-0010	CYLINDER BOLT(R)	2	E08
24	CF188-022014	0180-022014	WASHER, CYLINDER BOLT	4	E08
25	152MI-080008	0010-080008	DOWEL PIN φ8×14	2	E08
26	152MI-060012	0010-060012-0030	BOLT M6×30	2	E08
27	CF188-022005	0180-022005	VALVE, EXHAUST	2	E08
28	CF188-022003	0180-022003-0010	STUD M8×42	2	E08
29	CF188-022300	0180-022300	GASKET, EXHAUST PIPE	1	E08
31	CF188-022015	0180-022015	BREATHER HOSE	1	E08

32	QC/T621-1999-A6.5	30601-106520	CLAMP A6.5	2	E08
1	CF188-023500	0180-023500-0030	CLAMP, WATER HOSE	2	E09
2	CF188-023006	0180-023006	WATER INLET HOSE	1	E09
3	CF188-023005	0180-023005-0050	SLEEVE, WATER HOSE	1	E09
4	152MI-080013	0010-080013-0030	BOLT M6×22	2	E09
5	CF188-023001	0180-023001-0080	JOINT, WATER INLET	1	E09
6	CF188-023002	0180-023002	O-RING 24×2.5	1	E09
7	CF188-023100	0180-023100	CYLINDER	1	E09
8	CF188-023004	0180-023004	GASKET, CYLINDER	1	E09
9	CF188-023003	0180-023003	GASKET, TENSIONER	1	E09
10	CF188-023200	0180-023200-0080	TENSIONER	1	E09
11	152MI-021017	0010-021017-0030	BOLT M6×25	4	E09
12	CF188-011005	0180-011005	DOWEL PIN φ13×18	2	E09
13	CF188-023400	0180-023400	TIMING CHAIN GUIDE	1	E09
14	CF188-023300	0180-023300	TENSIONER PLATE	1	E09
15	152MI-021016	0010-021016	WASHER 8	1	E09
16	CF188-023007	0180-023007-0030	BOLT, TENSIONER PLATE	1	E09
1	CF188-024100	0180-024100	CAMSHAFT ASSEMBLY	1	E10
2	CF188-024001	0180-024001	TIMING SPROCKET	1	E10
3	CF188-024002	0180-024002	DOWEL PIN, TIMING SPROCKET	1	E10
4	CF188-024003	0180-024003	RETAINER	1	E10
5	GB/T5783/M6X10-10.9	30004-060010150	BOLT	2	E10
6	CF188-024200	0180-024200	TIMING CHAIN	1	E10
7	CF188-024004	0180-024004	CAMSHAFT SPACER	1	E10
1	CF188-032000	0180-032000	MAGNETO STATOR	1	E11
2	CF188-030001	0180-030001-0090	BOLT M6×30	3	E11
3	CF188-031000	0180-031000	MAGNETO ROTOR	1	E11
1	CF188-041000	0180-041000	CRANKSHAFT	1	E12
2	CF188-040003	0180-040003-0050	CLIP, PISTON PIN	2	E12
3	CF188-040002	0180-040002	PISTON PIN	1	E12
4	CF188-040004	0180-040004	PISTON	1	E12
5	CF188-0400A0	0180-0400A0	PISTON RING	1	E12
6	CF188-040001	0180-040001-0010	NUT M18×1.5 (L)	1	E12
7	CF188-160002	0180-160002	GEAR, BALANCER SHAFT	1	E12
8	CF188-160003	0180-160003	WOODRUFF KEY	1	E12
9	CF188-160001	0180-160001	BALANCER SHAFT	1	E12
10	CF188-160004	0180-160004	SPROCKET, BALANCE SHAFT	1	E12

11	CF188-160006	0180-160006	WASHER 10.2×28×2	1	E12
12	GB5783/M10X25	30004-100025830	BOLT M10×25	1	E12
13	152MI-040006	0010-040006	WOODRUFF KEY	1	E12
13-A	0180-040007	0180-040007	WOODRUFF KEY	1	E12
1	CF188-054000	0180-054000	CLUTCH	1	E13
2	CF188-A-053000	018A-053000	CLUTCH HOUSING	1	E13
3	CF188-051000	018A-051000	PRIMARY SHEAVE	1	E13
4	CF188-055000	0180-055000	BELT	1	E13
5	CF188-052000	0180-052000	SECONDARY SHEAVE	1	E13
1	CF188-051300	0180-051300	PRIMARY TIGHT PULLEY ASSY.	1	E14
2	CF188-051002	0180-051002	SHAFT COLLAR	1	E14
3	CF188-051204	0180-051204	OIL SEAL	2	E14
4	CF188-A-051200	018A-051200	PRIMARY LOOSE PULLEY ASSY.	1	E14
5	CF188-051100	0180-051100	ROLLERS	8	E14
6	CF188-051001	0180-051001	CAM	1	E14
7	CF188-051003	0180-051003	SLIDER	4	E14
1	CF188-052006	0180-052006	NUT	1	E15
2	CF188-052004	0180-052004	SECONDARY SPRING SOCKET	1	E15
3	CF188-052003	0180-052003	PRESSURE SPRING	1	E15
4	CF188-052002	0180-052002	SPACER	1	E15
5	CF188-052203	0180-052203	OIL SEAL 50×58×4	2	E15
6	CF188-052204	0180-052204	O-RING 56.5×1.9	2	E15
7	CF188-052200	0180-052200	SECONDARY LOOSE PULLEY ASSY.	1	E15
8	CF188-052005	0180-052005	GUIDE PIN	4	E15
9	CF188-052001	0180-052001	GUIDE RING	4	E15
10	CF188-052100	0180-052100	SECONDARY TIGHT PULLEY ASSY.	1	E15
1	CF188-053200	0180-053200	OVERRIDING CLUTCH	1	E16
2	CF188-053005	0180-053005	OIL SEAL 46×37.5×5.5, END FACE	1	E16
3	CF188-053100	0180-053100	CLUTCH HOUSING	1	E16
4	CF188-060003	0180-060003-0010	MAIN DRIVE SHAFT NUT	1	E16
1	CF188-054005	0180-054005	RETAINER	5	E17
2	CF188-054002	0180-054002	SIDE WASHER	1	E17
3	CF188-054004	0180-054004	WASHER	1	E17
4	CF188-054003	0180-054003	SPRING SEAT	1	E17
5	CF188-054001	0180-054001	RETURN SPRING, CLUTCH	5	E17
6	CF188-054200	0180-054200	PAWL ASSY.	5	E17
7	CF188-054100	0180-054100	FIXED PLATE ASSY.	1	E17

1	CF188-061007	0180-061007-0050	RETAINER 25	4	E18
2	CF188-062102	0180-062101	OUTPUT DRIVEN GEAR	1	E18
3	CF188-062101	0180-062101	DRIVE BEVEL GEAR SHAFT	1	E18
4	GB/T276/6305	30499-02501	BEARING	1	E18
5	CF188-062103	0180-062103	BEARING SEAT,DRIVE BEVEL GEAR	1	E18
6	172MM-060011	0110-060011-0030	BOLT M8×28	4	E18
7	CF188-062104	0180-062104-0010	BEARING LIMIT	2	E18
8	GB/T2673/M8x25	30124-080025810	SCREW	4	E18
9	CF188-062105	0180-062105	ADJUST SHIM, DRIVE BEVEL GEAR	1	E18
10	CF188-062106	0180-062106	DRIVE BEVEL GEAR	1	E18
11	CF188-062107	0180-062107-0010	LOCKNUT, BEVEL GEAR	1	E18
12	GB/T894.1/20	30801-02005	RETAINER	1	E18
13	CF188-061012	0180-061012	WASHER 20.5×30×1.5	2	E18
14	GB5846/T/K20X26X12	30402-02000	NEEDLE BEARING	1	E18
15	CF188-061013	0180-061013	SPROCKET, REVERSE GEAR	1	E18
16	CF188-069000	0180-069000	CHAIN, REVERSE GEAR	1	E18
17	CF188-061011	0180-061011	DRIVEN OUTPUT GEAR	1	E18
18	CF188-061001	0180-061001	DRIVEN SHAFT	1	E18
19	CF188-061008	0180-061008	SPLINE WASHER	2	E18
20	CF188-061009	0180-061009	BUSHING, DRIVEN HIGH RANGE GEAR	1	E18
21	CF188-A-061010	018A-061010	DRIVEN GEAR, HIGH RANGE	1	E18
22	CF188-061006	0180-061006	SLIDING BUSH, GEARSHIFT	1	E18
23	CF188-061005	0180-061005	DRIVEN GEAR, LOW RANGE	1	E18
24	CF188-061003	0180-061003-0010	WASHER 17.5×26×1	1	E18
25	CF188-061002	0180-061002-0010	BELL PLUG 12	1	E18
26	CF188-A-060004	018A-060004	MAIN SHAFT. GEARSHIFT	1	E18
27	CF188-060003	0180-060003-0010	NUT, MAIN TRANSMISSION SHAFT	1	E18
1	GB/T6185.2/M14x1.5-10	30209-140820	NUT	1	E19
2	CF188-060005	0180-060005-0050	WASHER,FRONT TRANSMISSION OUTPUT SHAFT NUT	1	E19
3	CF188-060100	0180-060100-0050	COUPLER, FRONT TRANSMISSION OUTPUT	1	E19
4	CF188-060007	0180-060007	OIL SEAL 44×60×6.7	1	E19
5	CF188-060008	0180-060008	BEARING RETAINER, FRONT OUTPUT SHAFT	1	E19
6	GB/T276/6205	30400-02501	BEARING	1	E19
7	CF188-062301	0180-062301	FRONT OUTPUT SHAFT	1	E19
8	CF188-062206	0180-062206	DRIVEN BEVEL GEAR	1	E19
9	GB/T276/6207c3	30400-03500	BEARING	1	E19
10	CF188-062204	0180-062204	BEARING LIMIT NUT	1	E19

11	GB/T276/63/22	30400-02200	BEARING	1	E19
12	CF188-062205	0180-062205	O-RING 88×2.5	1	E19
13	CF188-062202	0180-062202	ADJUST SHIM, DRIVEN BEVEL GEAR	as needed	E19
14	CF188-062201	0180-062201	BEARING SEAT, DRIVEN BEVEL GEAR	1	E19
15	172MM-060011	0110-060011-0030	BOLT M8×28	4	E19
16	CF188-062203	0180-062203	OIL SEAL B6 SD 30 46 7	1	E19
17	CF188-060006	0180-060006-0050	COUPLER, REAR TRANSMISSION OUTPUT	1	E19
18	CF188-060001	0180-060001-0050	WASHER, REAR OUTPUT SHAFT NUT	1	E19
19	CF188-060002	0180-060002-0010	NUT, REAR OUTPUT SHAFT	1	E19
1	GB/T894.1/12	30801-01205	RETAINER	3	E20
2	CF188-063002	0180-063002	LEFT SHIFT FORK	1	E20
3	CF188-063003	0180-063003-0050	SPRING, SHIFT FORK	1	E20
4	CF188-063001	0180-063001	GUIDE BAR	1	E20
5	CF188-063004	0180-063004	RIGHT SHIFT FORK	1	E20
6	CF188-063005	0180-063005-0050	SPRING, SHIFT FORK	1	E20
7	CF188-063006	0180-063006-0010	SPRING SEAT	2	E20
8	CF188-064002	0180-064002-0050	FASTEN SCREW T25	1	E20
9	CF188-064003	0180-064003-0050	GEAR CONTACTOR	1	E20
10	CF188-064004	0180-064004-0050	SPRING, GEAR CONTACTOR	1	E20
11	CF188-064001	0180-064001-0010	LIMIT WASHER	1	E20
12	CF188-064005	0180-064005	SHIFT CAM	1	E20
13	GB/T308/3/8	3120003	FRICITION BALL	1	E20
14	CF188-068002	0180-068002	WASHER 14×22×1	1	E20
15	CF188-068001	0180-068001-0050	HOLE BOLT M14×1.5	1	E20
16	CF188-068003	0180-068003-0050	LIMIT SPRING	1	E20
17	CF188-065201	0180-065201-0010	WASHER, DRIVEN SECTOR GEAR	1	E20
18	CF188-065202	0180-065202-0050	SHAFT, DRIVEN SECTOR GEAR	1	E20
19	CF188-065203	0180-065203	DRIVEN SECTOR GEAR	1	E20
20	CF188-065204	0180-065204-0050	WASHER 13.5×22×1	1	E20
21	CF188-065205	0180-065205-0010	TORSION SPRING, DRIVEN SECTOR GEAR	1	E20
22	CF188-065206	0180-065206-0010	WASHER 6.6×20×2	1	E20
23	152MI-013008	0010-013008-0030	BOLT M6×35	1	E20
24	152MI-021017	0010-021017-0030	BOLT M6×25	3	E20
25	152MI-080012	0010-080012-0030	BOLT M6×32	1	E20
26	CF188-065004	0180-065004-0030	CLIP	1	E20
27	152MI-023010	0010-023010-0030	BOLT M6×20	1	E20
28	CF188-065206	0180-065206-0010	GASKET 6.6×20×2	1	E20

29	CF188-065300	0180-065300-0010	ROCKER ARM, GEARSHIFT	1	E20
30	CF188-065001	0180-065001-0080	COVER, SECTOR GEAR HOUSING	1	E20
31	CF188-065002	0180-065002	OIL SEAL SD 15 25 5	1	E20
32	CF188-065100	0180-065100	WELD PART, DRIVE SECTOR GEAR	1	E20
33	152MI-08008	0010-080008	DOWEL PIN ϕ 8×14	1	E20
34	CF188-065003	0180-065003	GASKET, SECTOR GEAR HOUSING	1	E20
1	CF188-073000	0180-073000	RELIEF VALVE	1	E21
2	GB/T894.1/11	30801-01100	RETAINER 11	1	E21
3	CF188-070003	0180-070003	SPROCKET, OIL PUMP	1	E21
4	CF188-074000	0180-074000	CHAIN, OIL PUMP	1	E21
5	CF188-070002	0180-070002	WASHER, OIL PUMP	1	E21
6	CF188-070004	0180-070004-0090	BOLT M6×40	3	E21
7	CF188-071001	0180-071001	SHAFT, OIL PUMP	1	E21
8	CF188-071002	0180-071002	ROTOR COVER	1	E21
9	CF188-071005	0180-071005	OUTER ROTOR,OIL PUMP	1	E21
10	CF188-071006	0180-071006	INNER ROTOR,OIL PUMP	1	E21
11	CF188-071003	0180-071003	DOWEL PIN	2	E21
12	CF188-071007	0180-071007	STRAIGHT PIN	1	E21
13	CF188-071004	0180-071004	OIL PUMP HOUSING	1	E21
14	GB/T822/M5x20	30129-050020420	SCREW M5×20	1	E21
15	CF188-072000	0180-072000	OIL STRAINER	1	E21
16	172MM-090008	0110-090008-0030	BOLT M6×14	1	E21
17	CF188-071008	0180-071008	O-RING 14×2.5	1	E21
18	CF188-071000	0180-071000	OIL PUMP	1	E21
A	CF188-081000	0180-081000	WATER PUMP	1	E22
1	1P52MI-011018	0020-011018-0030	BOLT M6×70	1	E22
2	152MI-013010	0010-013010-0030	BOLT M6×50	1	E22
3	152MI-060012	0010-060012-0030	BOLT M6×30	2	E22
4	152MI-021019	0010-021019-0030	BOLT M6×12	1	E22
5	152MI-060009	0010-060009	WASHER 6	1	E22
6	CF188-081100	0180-081002-0080	COVER, WATER PUMP	1	E22
7	CF188-081001	0180-081001	IMPELLER	1	E22
8	CF188-081006	0180-081006	GASKET	1	E22
9	152MI-081000	0010-081000	WATER SEAL	1	E22
10	CF188-081004	0180-081004-0050	WATER PUMP SHAFT	1	E22
11	CF188-081002	0180-081100	HOUSING, WATER PUMP	1	E22
12	172MM-080005	0110-080005	OIL SEAL 10×20×5	1	E22

13	GB/T276/6000	30400-01000	BEARING 6000	1	E22
14	GB/T894.1/10	30801-01005	RETAINER 10	1	E22
15	CF188-080002	0180-080002	O-RING 34×2.5	1	E22
16	CF188-082000	0180-082000	WATER OUTLET PIPE	1	E22
17	CF188-080001	0180-080001	O-RING 21×2.5	1	E22
18	152MI-021019	0010-021019-0030	BOLT M6×12	1	E22
1	GB/T70.1/M8x20	30102-080020820	SCREW M8×20	6	E23
2	CF188-091200	0180-091200	OVERRIDING CLUTCH	1	E23
3	GB/T5801/49/22	30401-02800	NEEDLE BEARING	1	E23
4	CF188-091001	0180-091001	DRIVEN GEAR	1	E23
5	CF188-091007	0180-091007	SPACER	1	E23
6	CF188-091003	0180-091003	IDLE GEAR BUSHING	1	E23
7	CF188-091004	0180-091004	IDLE GEAR SHAFT	1	E23
8	CF188-091002	0180-091002	IDLE GEAR	1	E23
9	CF188-091006	0180-091006	AXLE, DUAL GEAR	1	E23
10	CF188-091005	0180-091005	DUAL GEAR	1	E23
11	CF188-091100	0180-091100-0010	STARTING MOTOR	1	E23
12	152MI-060012	0010-060012-0030	BOLT M6×30	2	E23
13	CF188-014010	0180-014010	CLAMP	1	E23
A	CF188-100000	0180-100000	CARBURETOR	1	E24
1	CF188-100003	0180-100003	GUIDE HOLDER	1	E24
2	CF188-100004	0180-100004	O-RING	1	E24
3	CF188-100005	0180-100005	COMPRESSION SPRING	1	E24
4	CF188-100006	0180-100006	PLUNGER ASSY	1	E24
5	CF188-100007	0180-100007	FUEL ENRICH VALVE	1	E24
6	CF188-100008	0180-100008	VACUUM DIAPHRAM	1	E24
7	CF188-100009	0180-100009	PLUNGER VALVE	1	E24
8	CF188-100010	0180-100010	NUT VM13/43	1	E24
9-1	GB818/M4	30105-040006420	BOLT M4×6	3	E24
9-2	GB818/M4	30105-040008420	BOLT M4×8	3	E24
10-1	CF188-100002	0180-100002	THROTTLE COVER	1	E24
10-2	CF188-100002	0180-100002-0001	THROTTLE COVER	1	E24
11	CF188-100011	0180-100011	VACUUM COVER	1	E24
12	CF188-100012	0180-100012	SPRING	1	E24
13	CF188-100013	0180-100013	OIL NEEDLE CAGE	1	E24
14	CF188-100014	0180-100014	SPRING	1	E24
15	CF188-100100	0180-100100	FUEL NEEDLE COMP.	1	E24

16	CF188-100015	0180-100015	MAIN JET	1	E24
17	CF188-100016	0180-100016	MAIN NOZZLE	1	E24
18	CF188-100017	0180-100017	IDLE AIR JET	1	E24
19	CF188-100018	0180-100018	IDLE METERING JET	1	E24
20	CF188-100019	0180-100019	STARTING JET	1	E24
21	CF188-100200	0180-100200	FUEL NEEDLE VALVE COMP.	1	E24
22	CF188-100020	0180-100020	FLOAT	1	E24
23	CF188-100021	0180-100021	FLOAT CHAMBER	1	E24
24	CF188-100022	0180-100022	FUEL DRAIN BOLT	1	E24
25	CF188-100023	0180-100023	IDLE ADJUSTING CABLE	1	E24
A	CF188-A-180000	018A-180000	FAN ASSY.	1	E25
1	152MI-023010	0010-023010-0030	BOLT M6×20	12	E25
2	CF188-A-180007	018A-180007	LONG SPACER	4	E25
3	CF188-A-180006	018A-180006	HOUSING,FAN	1	E25
4	CF188-A-180001	018A-180001	SPACER	8	E25
5	CF188-A-180005	018A-180005	IMPELLER,FAN	1	E25
6	CF188-331004	0180-331004	O-RING 64.5×3	1	E25
7	CF188-A-180002	018A-180002	PLATE	1	E25
8	CF188-092001	0180-092001-0050	BOLT M10×1.25×40	1	E25
9	CF188-A-180004	018A-180004	WASHER 10.2×28×3	1	E25
10	CF188-092102	0180-092102	O-RING 16.1×3.2	1	E25
11	CF188-A-180003	018A-180003	JOINT,FAN	1	E25
12	CF188-A-180100	018A-180100	SEAT PLATE	1	E25

E08 CYLINDER HEAD

DRAWING

CF188-A ENGINE

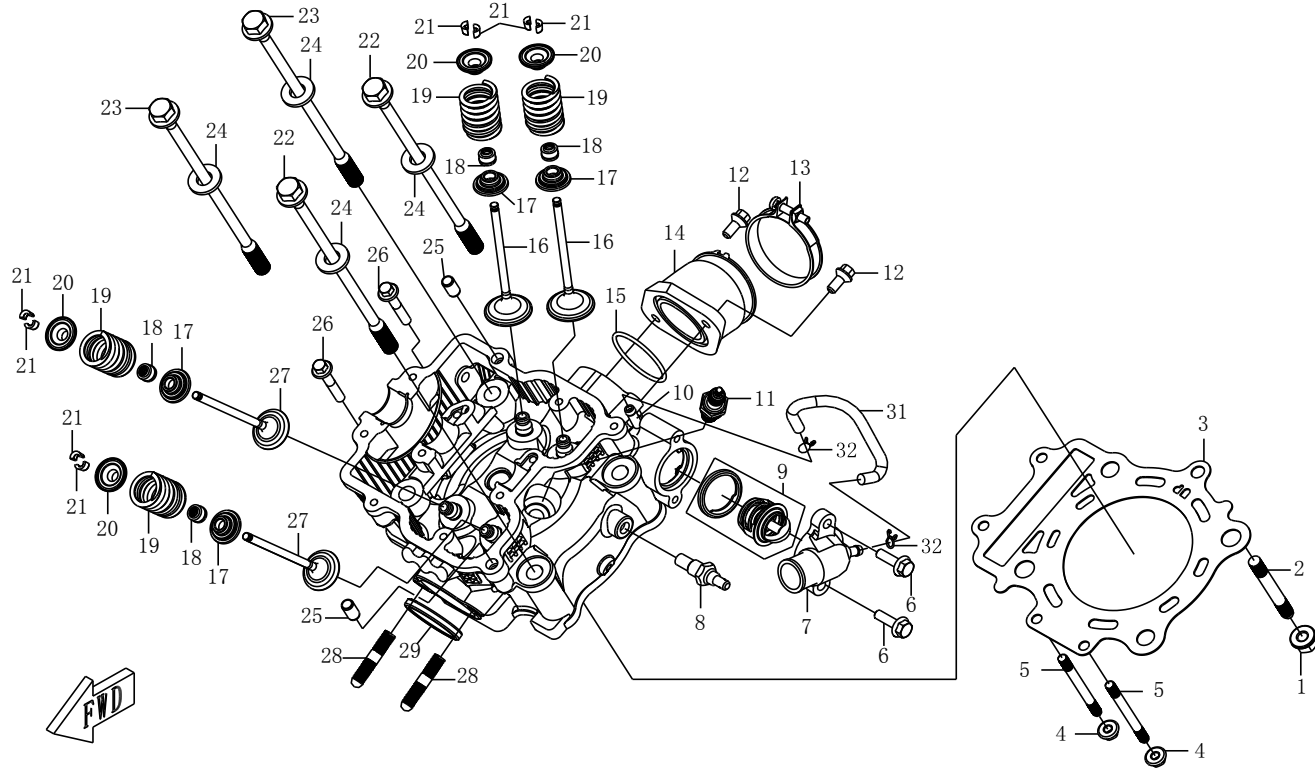

Item No.	Old Part No.	New Part No.	Part Name(EN)	Qty
				CF188-A
1	152MI-011700	0010-011700-0010	THRUST NUT M8	1
2	CF188-022009	0180-022009-0010	STUD M8×68	1
3	CF188-022200	0180-022200	GASKET,CYLINDER HEAD	1
4	GB/T6187.1/M6	30204-060810	NUT	2
5	CF188-022001	0180-022001-0020	STUD M6×70	2
6	152MI-080013	0010-080013-0030	BOLT M6×22	2
7	1P72MM-022200	01A0-022200	WATER OUTLET JOINT, CYLINDER HEAD	1
8	152MI-022600	0010-022600	WATER TEMPERATURE SENSOR	1
9	CF188-022810	0180-022810	THERMOSTAT	1
10	1P72MM-022102	01A0-022102	PIPE JOINT	1
11	172MM-022400	0110-022400	SPARK PLUG	1
12	CF188-022010	0180-022010-0010	SCREW M6	2
13	CF188-022400	0180-022400-0050	AIR INLET PIPE CLAMP	1
14	CF188-022900	0180-022900	JOINT, CARBURETOR	1
15	CF188-022011	0180-022011	O-RING 40×2.4	1
16	CF188-022004	0180-022004	VALVE, INTAKE	2
17	CF188-022008	0180-022008-0050	LOWER SEAT, VALVE SPRING	4
18	152MI-022500	0010-022500	SEAL RING SET, VALVE STEM	4
19	CF188-022006	0180-022006-0050	VALVE SPRING	4
20	CF188-022007	0180-022007-0050	UPPER SEAT	4
21	152MI-022006	0010-022006-0030	LOCK CLIP, V	8
22	CF188-022012	0180-022012-0010	CYLINDER B	2
23	CF188-022013	0180-022013-0010	CYLINDER B	2
24	CF188-022014	0180-022014	WASHER, CY	4
25	152MI-080008	0010-080008	DOWEL PIN	2
26	152MI-060012	0010-060012-0030	BOLT M6×30	2
27	CF188-022005	0180-022005	VALVE, EXHA	2
28	CF188-022003	0180-022003-0010	STUD M8×42	2
29	CF188-022300	0180-022300	GASKET, EXH	1
31	CF188-022015	0180-022015	BREATHER H	1
32	QC/T621-1999-A6.5	30601-106520	CLAMP A6.5	2
			DISCONTINUED	
32-A		30601-207050	CLAMP A6.5	2
			NEWLY IMPROVED	

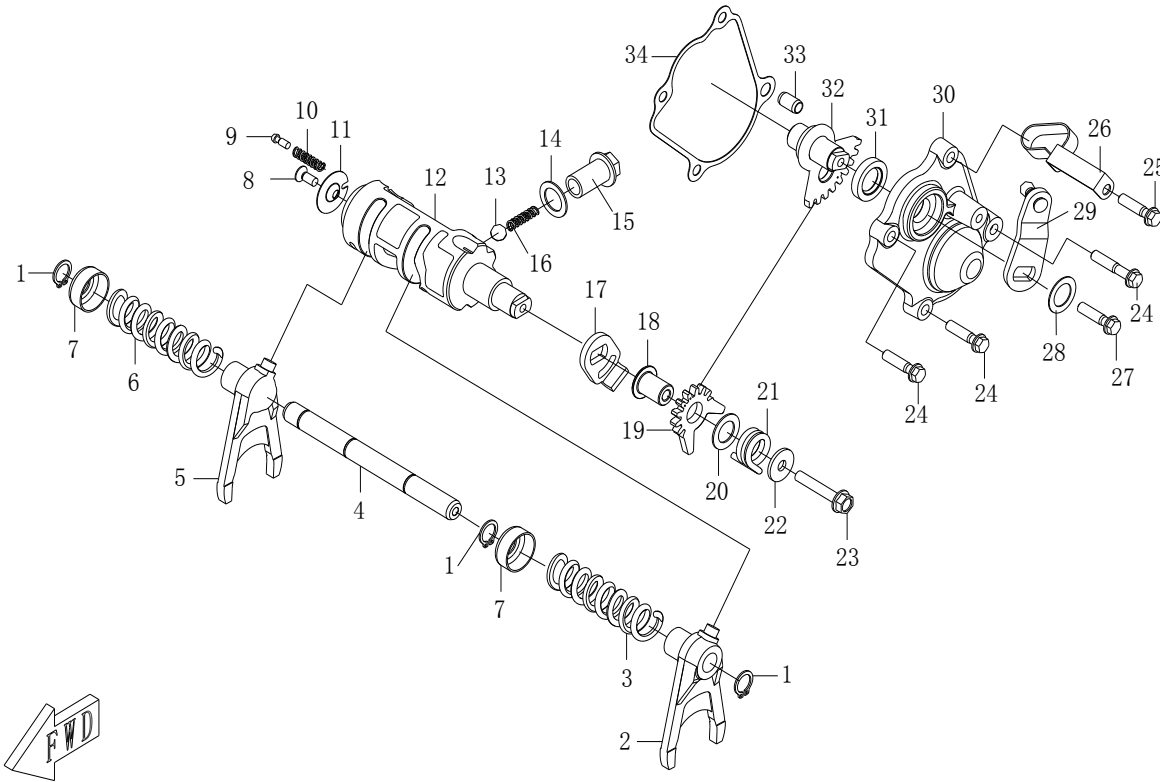

Item No.	Old Part No.	New Part No.	Part Name(EN)	Qty
				CF188-A
1	GB/T894.1/12	30801-01205	RETAINER	3
2	CF188-063002	0180-063002	LEFT SHIFT FORK	1
3	CF188-063003	0180-063003-0050	SPRING, SHIFT FORK	1
4	CF188-063001	0180-063001	GUIDE BAR	1
5	CF188-063004	0180-063004	RIGHT SHIFT FORK	1
6	CF188-063005	0180-063005-0050	SPRING, SHIFT FORK	1
7	CF188-063006	0180-063006-0010	SPRING SEAT	2
8	CF188-064002	0180-064002-0050	FASTEN SCREW T25	1
9	CF188-064003	0180-064003-0050	GEAR CONTACTOR	1
10	CF188-064004	0180-064004-0050	SPRING, GEAR CONTACTOR	1
11	CF188-064001	0180-064001-0010	LIMIT WASHER	1
12	CF188-064005	0180-064005	SHIFT CAM	1
13	GB/T308/3/8	3120003	FRICTION BALL	1
14	CF188-068002	0180-068002	WASHER 14×22×1	1
15	CF188-068001	0180-068001-0050	HOLE BOLT M14×1.5	1
16	CF188-068003	0180-068003-0050	LIMIT SPRING	1
17	CF188-065201	0180-065201-0010	WASHER, DRIVEN SECTOR GEAR	1
18	CF188-065202	0180-065202-0050	SHAFT, DRIVEN SECTOR GEAR	1
19	CF188-065203	0180-065203	DRIVEN SECTOR GEAR	1
20	CF188-065204	0180-065204-0050	WASHER 13.5×22×1	1
21	CF188-065205	0180-065205-0010	FRISON SPRING, DRIVEN SECTOR GEAR	1
22	CF188-065206	0180-065206-0010	WASHER 6.6×20×2	1
23	152MI-013008	0010-013008-0030	BOLT M6×35	1
24	152MI-021017	0010-021017-0030	BOLT M6×25	3
25	152MI-080012	0010-080012-0030	BOLT M6×32	1
26	CF188-065004	0180-065004-0030	CLIP	1
27	152MI-023010	0010-023010-0030	BOLT M6×20	1
28	CF188-065206	0180-065206-0010	GASKET 6.6×20×2	1
29	CF188-065300	0180-065300-0010	ROCKER ARM, GEARSHIFT	1
30	CF188-065001	0180-065001-0080	COVER, SECTOR GEAR HOUSING	1
31	CF188-065002	0180-065002	OIL SEAL SD 15 25 5	1
32	CF188-065100	0180-065100	WELD PART, DRIVE SECTOR GEAR	1
33	152MI-080008	0010-080008	DOWEL PINφ8×14	1
34	CF188-065003	0180-065003	GASKET, SECTOR GEAR HOUSING	1

