



HONDA

Owner's Manual

TDR01Z (JUCHI) Bicycle



Information To Know Before riding

Know-How Of Using Bicycle

Driving operation instructions

Trouble Shootings

Daily maintenances

Technical Information

Circuit Diagram

List

Thank you very much for buying a HONDA Electric Bicycle

A FEW WORDS ABOUT SAFETY

Your safety, and the safety of others, is very important. And operating this electric bicycle safely is an important responsibility. To help you make informed decisions about safety, we have provided operating procedures and other information on labels and in this manual. This information alerts you to potential hazards that could hurt you or others.

⚠ DANGER

You CAN be HURT if you don't follow instructions.

⚠ WARNING

You CAN be HURT if you don't follow instructions.

⚠ CAUTION

You CAN be HURT if you don't follow instructions.

Catalogue

1 Information To Know Before Riding

Electric bicycle structures
Safety instructions
Load capacity
Riding Safely

Road conditions
Parking
Environmental protection

2 Ways of using Electric Bicycle

The Ways Of Using Bicycle
How to charge
How to install the battery box

How to install the battery
How to use Lights and horn
Tire inflation

3 Driving operation instructions

Riding instructions
Attention before riding
Checking battery capacity
How to check and adjust chain

How to check and adjust brake system
Seat and handlebar adjustment
Starting and riding

4 Trouble shooting

Trouble shooting

5 Daily maintenance

Controller specifications

Motor maintenance
Battery maintenance

6 Bicycle Parameter

Bicycle Parameter

7 Circuit Diagram

Circuit Diagram

Introduce bicycle structure

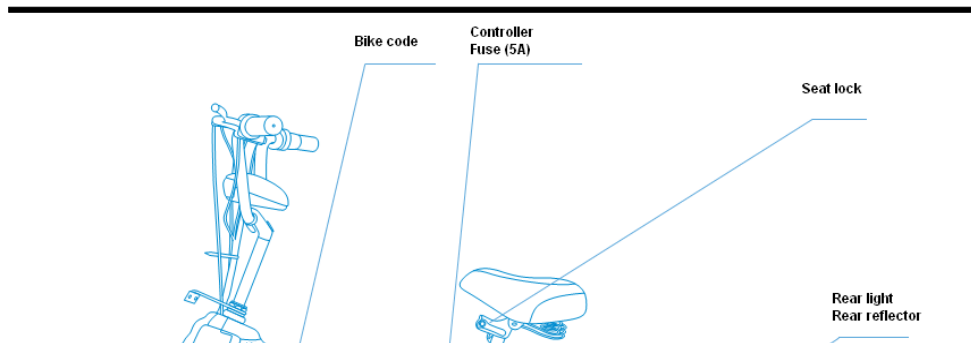
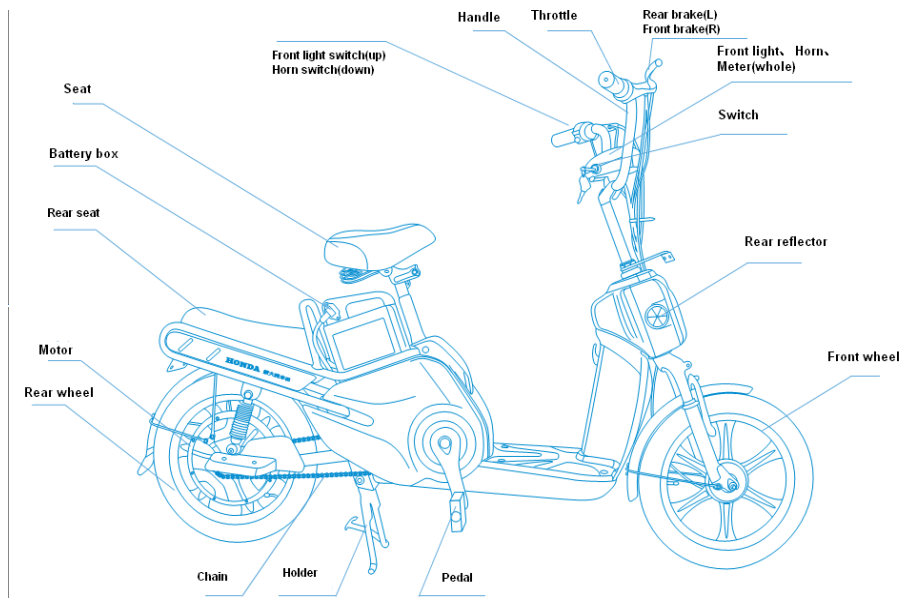

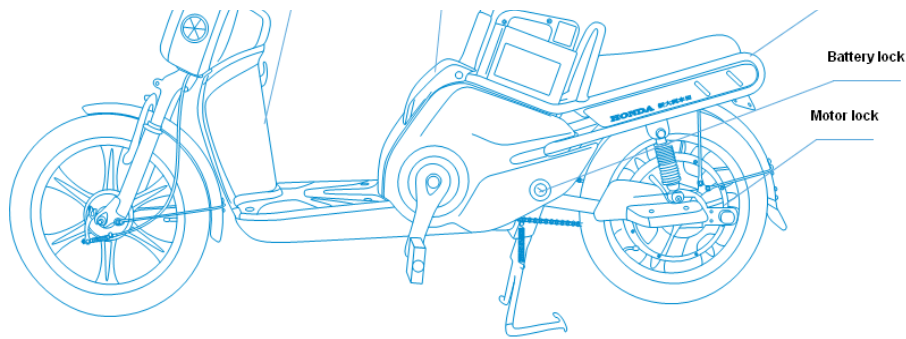

Safety using information

- 1 Obey local laws and road regulations, keep your speed under 20KM/H.
- 2 Do not drive on automobile lanes.
- 3 Please read our Owner's Manual carefully. Don't lend the electric bicycle to people who do not know how to ride.
- 4 Always make sure the brakes are working well. Always ride slowly when going down hill or when riding in bad weather.
- 5 Frequently adjust the brakes and change the brake pads when worn down.
- 6 Do not modify this electric bicycle in order to obtain higher speed.
- 7 Always leave plenty of room between your bike and somebody in front so that you can stop on time

⚠ WARNING

The max speed of the Honda electric bicycle is 20Kph.

Load capacity

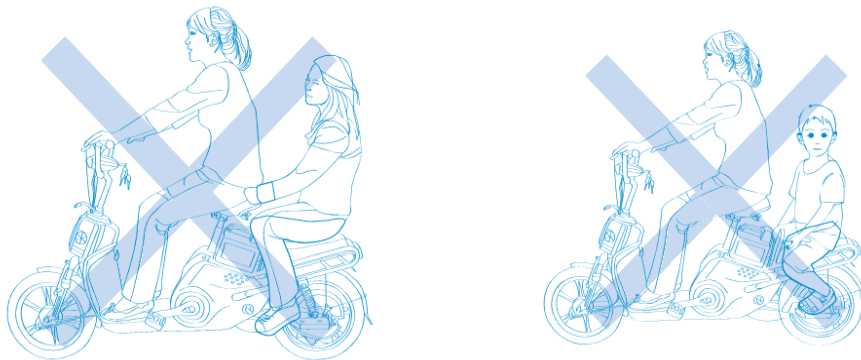

The max load capacity is 100kg.

Riding Safely



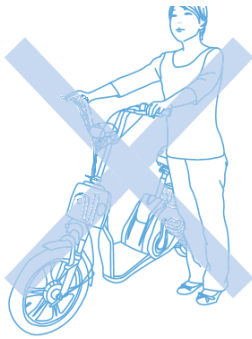

Do not turn throttle before you are riding

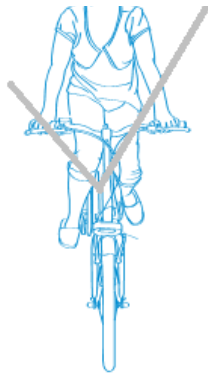

Correct Sudden braking and single hand riding is prohibited



Riding Safely

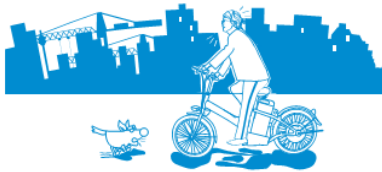

Turn on the lights when you are riding at night

Parking



Brake gently when you want to park and do not use the throttle.

Bicycle refitting



Do not install non-original HONDA spare parts.

Environmental protection

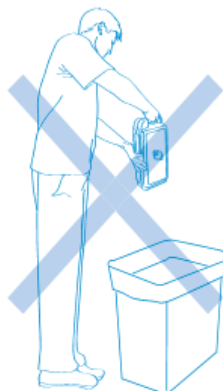

Always dispose of old batteries properly.

How to charge

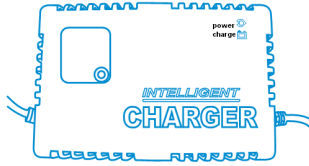

1 The charger is HONDA special one, 110v AC.

2 Firstly, open the charging input socket, plug the connector of adapter charger into the charging socket. On the other side, plug the power adapter into electric source. Be sure to turn off the power switch when charging without remove battery pack from bike.

3 when charging, the charger indicator light as below

Power on	power light green, charging light green.
Charging	power light green, charging light red.
Finish	power light green, charging light red off.
Charger problems	power light green, charging light red, shining frequently.
Battery problems	power light green, charging light red, shining slowly.

CAUTION

1. Please charge in dry and ventilated indoor condition. If in wet and/or damp condition, it might lead to destroy charger and cause fire.
2. Please don't cover anything on charger when charge, it will cause over heating or fire.
3. Do not charge close to petrol when in order to avoid fire.
4. Using other brand charger may damage battery and/or other risks.
6. Disconnect the plug from power after charging is finished, otherwise, it may damage charger.
7. Keep children far away from battery when charging.

Ways of remove/install battery case

Remove: Put the seat up, turn the key to "battery case open" position and remove the battery case.

Install: Put battery box in the position, turn seat down and lock, then, turn back key in power off position.

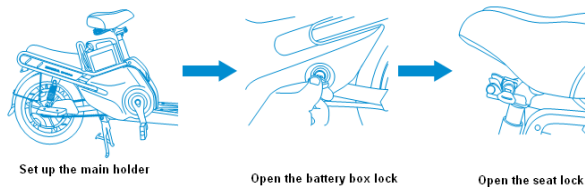

Caution:

Please make sure the battery like right picture after remove from bike. Don't lie flat to avoid electrolyte outflow.

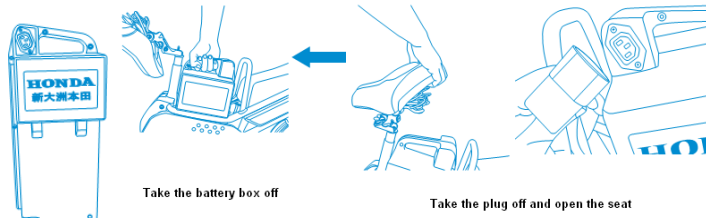

The Method Of Using Bicycle

How to install battery

following steps to install battery

A: install "+" terminal (red wire), then install "-" terminal (green wire)

- B: use insulating tape to cover the terminals
- C: put the batteries in the case easily and smoothly.
- D: cover the case and screw tightly.

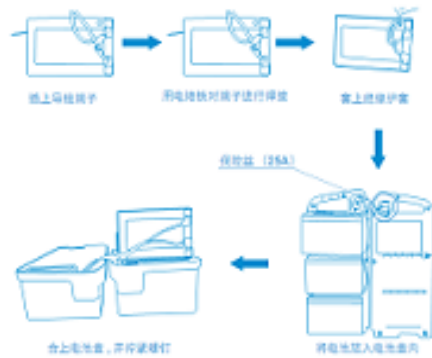

Ways of wires installation.

How to use Lighting and horn

Front light and horn are above front fender.
The switch for the lights and the horn button are on the left handle.

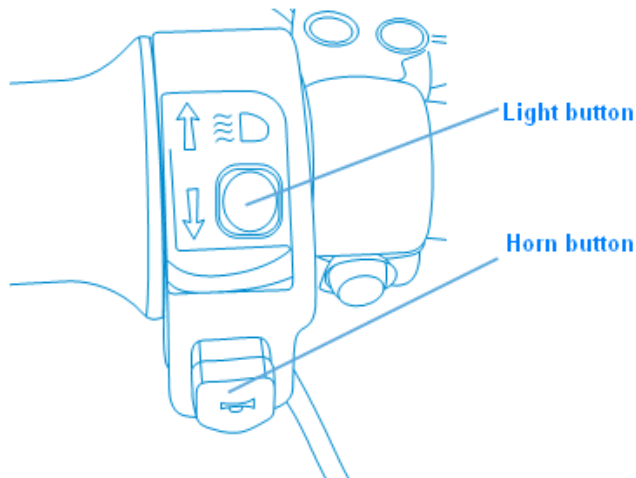

Tire inflation

Please be sure the tires are not overly worn and and regularly check the pressure.

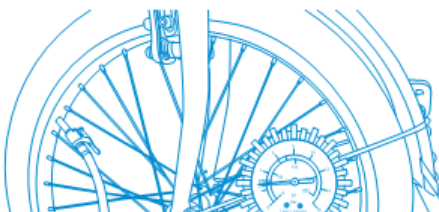

Front wheel standard tire pressure
250KPS-36PSI

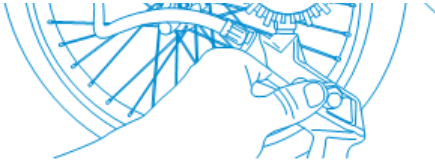

Rear wheel standard tire pressure
300KPS-44PSI

⚠ WARNING

Over inflation may cause the tire to burst.

Some notice before riding

Please check below notice before riding to guarantee safe riding.

- 1、 please make sure the height and verticality of handle is comfortable
- 2、 please make sure the electricity is enough.
- 3、 please make sure the height and verticality of seat is comfortable
- 4、 please make sure the chain is fine.
- 5、 please make sure the axle nuts are tight
- 6、 make sure front and rear reflector are clean
- 7、 make sure tire pressure is fit
- 8、 Please make sure brake system is fine
- 9、 please make sure the brake block are fine

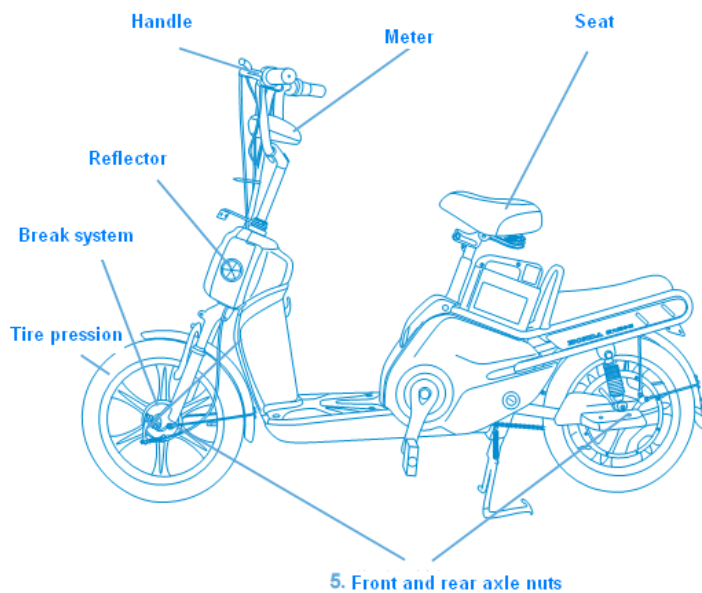

How to check the battery power

When turn on, the LEDs show 3 green lights and 1 red light. If green lights on, you can drive, if red light on, you should charge the battery.

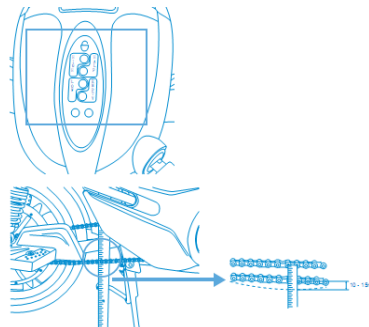

Checking the chain

The sagging must be between 10-15mm

Adjusting the sagging

Adjust the screw and clamp nut to meet the standard (10-15mm). When adjust, you should keep the chain line up.

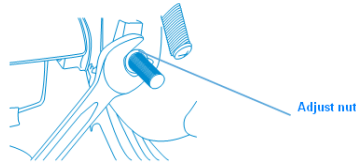

⚠ WARNING

If the sag is not between 10-15mm, it might cause the chain to fall off or break the chain.

How to check the brake system

Check

The distance between lever and handle bar should be 25mm-35mm.



Adjusting

Clockwise/Anticlockwise adjust the bolts in order to meet the standard (25mm-35mm).

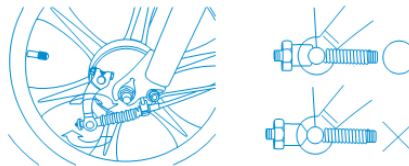

If you still cannot brake appropriately, you can adjust the inner brake cable length.

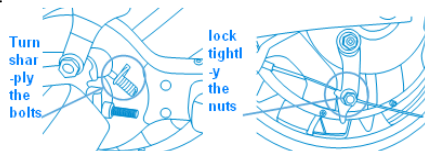

How to adjust the height of the handle bar and seat

Checking

It already was checked prior to delivery to distributors or end users. We do not suggest you adjust yourself.

If it is loose, you can adjust bolts. Never raise the handlebar to beyond the safety line shown on right picture. You must make the torque at 20N•m

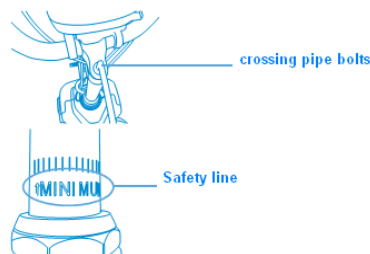

If the height of the saddle is not suitable you can adjust the seat height up to the safety line. You have to make the torque 27N•m.

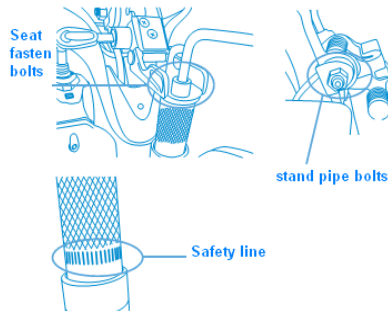

Starting and Driving

1. before starting, you should check the vehicle and road condition;
2. turn on, check the battery power, lights, horn, brake, tyres and so on;
3. push off the side stand, seat on saddle, turn the throttle slowly.

Attention when driving

You should pedal when you ride uphill or against head wind in order to decrease the discharge current and protect the battery.

▲ DANGER

It is prohibited to ride when the surface water is over the outer edge of the motors. It will damage the controller and motor.

Trouble Shooting

Problems	Reasons	Trouble shooting
Cannot charge the battery	1. poor connection between the charge plug and battery socket, conductor disconnection.	re-connect the conductor or weld the wire.
	2. the wires between batteries set drop	re-connect the wires.
	3. charger problem	repair or change new one
	4. fuse broken	change new one
Turn on, this is no power	1. fuse broken	change new one
	2. the battery plugs poor contact	repair or re-connect
	3. the switch is wrong or conductor poor contact	change power switch or check the conductor
Turn on, LEDs indicate the power but the motor does not work	1. throttle has problem	change a new one
	2. power brake malfunction	change a new one
	3. controller has problem	change a new one
	4. motor has problem	repair or change a new one
After fully charging, the range is short	1. Insufficient power	check whether the connector is well contacted
	2. Battery performance degradation	change a new set
	3. The pressure of tyre is insufficient	tire inflation
	4. the brakes are misadjusted	adjust the brake distance
	5. front/rear wheel stagnation	lubricate, adjust or change the axle bearing

Controller spec. and how to work

1. Basic Specs.

Type: 1B100-D01A-1A00

Voltage: DC48V

Holzer phase: 120 Degree

Max current: 15+-1A

2. This controller is specifically designed for electric bicycle. It has a single smart chip inside, control the speed, brake power, overvoltage protection, current limiting protection, speed limits, anti-coaster protection and temperature protection. it is reliable to ensure that electric bicycle drive system in the best condition to work.

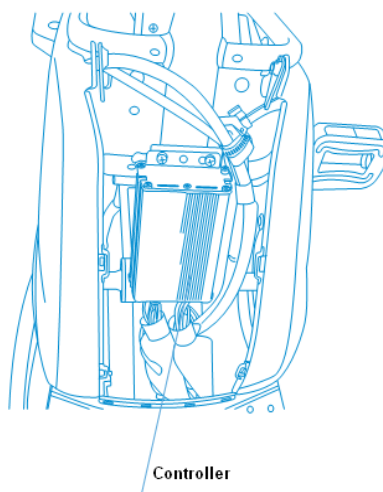

3. No necessary daily maintenance but be sure

not let water in.

Motor maintenance

Brushless motor with high performance rare earth Nd-Fe-boron permanent magnet material. External rotor direct drive wheel rotation. The output torque is big, long life, low maintenance, low noise, etc. The motor wheel will issue a "buzzing" sound during operation, The sound of the vibration is a normal phenomenon.
 Motor usually do not require special maintenance, running 2000 hours totally.
 Be sure the water surface may not be higher the lower edge of the motor, otherwise it might cause a short circuit and damage the motor.

Battery maintenance

Sealed lead-acid batteries with large capacity, longevity, easy maintenance, etc..
 Charging time is more than 10 hours for the first charge.
 If not riding for a long time, due to natural discharge, the power will decrease gradually.
 Please charge on a regular basis (charging period is one month). Never fully discharge.



The battery is sealed, no need to add distilled water. It is strictly prohibited prying open to add the water.
 Prying open add fluid

Bicycle Parameter

No.	SPECIFICATION	
1	Max. Speed:	≤20km/h
2	Net Weight:	54kg(incl battery)
3	Rated Load Capacity:	75kg
4	Distance per charge:	40km
6	Size (LxWxH):	1640×690×1040mm
7	Axle distance:	1185mm
8	Consumption per 100km:	1 kW·h
9	Max noise:	51.9 DB(A)
11	Battery:	48V 12Ah Lead acid
	Type:	Dc brushless
	Rated output:	240W
12	Motor:	Rated voltage: 48V
		Rated rotation speed (r/min) 360
		Rated torque (N.m) 9
13	Controller	Voltage protection 42+-1
		Current limits 15+-1

Circuit Diagram

